

Cotswold Road North, Windmill Hill & Fraser Street junction improvment, Windmill Hill local traffic scheme

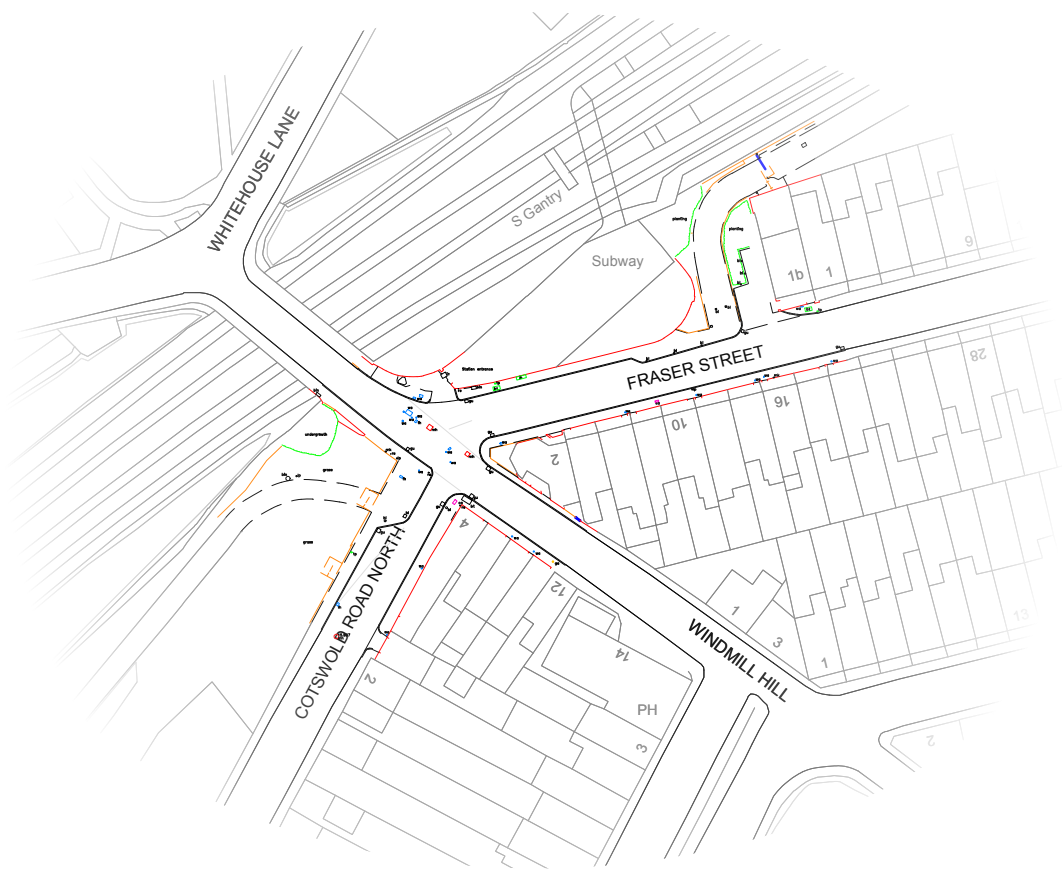

travelwest



This is a combined consultation for two proposed highway improvements schemes in the Windmill Hill area.

The Cotswold Road North, Windmill Hill and Fraser Street junction improvement seeks to improve crossing facilities for pedestrians and cyclists.

The Windmill Hill local traffic scheme seeks to deter through traffic using the local roads.

Introduction

Bristol has been awarded additional funding from the UK government to upgrade and extend walking and cycling routes across the city. With Council funding included, a total of £19m has been allocated for projects from 2015 to 2018 in the Bristol area.

One of these routes is the Malago Greenway. We are working to make this route a quiet, safe and enjoyable route to get people to work or play all year round. Improving facilities for pedestrians and cyclists along the Malago Greenway will help give communities in South Bristol a better, healthier alternative for transport.

To find out more information of other routes and initiatives being financed by the Cycle Ambition Fund, visit **www.travelwest.info/projects/cycle-ambition-fund**

Documents available in other formats:

If you would like this information in another language, Braille, audio tape, large print, easy English, BSL video or CD rom or plain text please contact:

CAF@bristol.gov.uk

Junction Improvement – Initial Community Engagement

- ▶ Earlier this year, we:
- ▶ Held pop-up events along the Malago Greenway route
- ▶ Held 3 public events outside Bedminster Station
- ▶ Raised awareness on social media
- ▶ Discussed proposals with directly affected residents

Speaking to users of the existing path at three locations allowed us to get a picture of existing issues. Using an interactive on-line map, people were able to comment on any aspect of the existing route. This engagement gave us an understanding of aspirations for improvements. Common issues were raised and the top 6 key issues were:

- ▶ Unsafe (existing fear of crime)
- ▶ Barriers
- ▶ Lighting
- ▶ Crossings
- ▶ Cycle path needed
- ▶ Dangerous (existing road safety)

Local Traffic Scheme

The local Neighbourhood Partnership previously identified through traffic in the area as a problem.



Junction Improvement – Proposal

The existing junction is to be improved to help pedestrians and cyclists cross the location. The proposal includes:

- ▶ narrowing Windmill Hill carriageway to form a priority arrangement
- ▶ providing a raised table to help pedestrians and cyclists cross the road
- ▶ a new one-way system eastbound along Fraser Street
- ▶ removing section of parking spaces on north side of Fraser Street, with existing footway widened to let cyclists use it
- ▶ resurfacing existing footway areas, with new tactile paving at crossing points
- ▶ providing new sitting area, planting and cycle parking
- ▶ proposed removal of barriers into the Cotswold Road North open space area to improve accessibility
- ▶ additional sections of double yellow lines to improve visibility and safety

The proposed improvements are shown on the engineering drawing on the following pages.



Local Traffic Scheme – Proposal

The improvement will result in a number of benefits, including:

- ▶ revised parking restrictions on Windmill Hill to change the location of parked vehicles making the southerly journey more awkward
- ▶ improved pedestrian area on Windmill Hill and a new informal loading area for the Public House
- ▶ narrower junctions with improved crossing facilities where Windmill Hill meets Eldon Terrace and Alfred Place
- ▶ the scheme also includes a small narrowing on Cotswold Road which will be consulted on separately with the directly affected residences

"A lot of people cross the road at this point, between Cotswold Road and Fraser street, to access the park, St Mary Redcliffe junior School, the station, or just heading towards Bedminster, so they are on the right side of Windmill Hill to access the zebra on Whitehouse Lane. Traffic flows outside the peaks are light however during the morning peak especially, when loads of parents walk young kids to school, there is a lot of conflict here between pedestrians and rat-running traffic, so some kind of crossing facility would be very welcome, and would benefit cyclists also."

"...this barrier makes the path totally inaccessible to wheelchair/disability vehicle users and very awkward for baby buggies."

Junction Improvement – Benefits

The improvement will result in a number of benefits, including:

- ▶ improve road safety by slowing vehicles using the junction
- ▶ new one-way system will reduce conflicting movements at the junction and along Fraser Street, which is very narrow
- ▶ improved crossing facilities for users travelling along the Malago Greenway
- ▶ resurfaced footways and fewer trip hazards, helping people with mobility difficulties
- ▶ new seating, more planting and cycle parking will enhance the area
- ▶ tactile paving helps visually impaired users be more aware of crossing points
- ▶ improved accessibility into the open space area, especially for people with mobility difficulties

"This section could be improved by disallowing parking on the north side of Fraser Street alongside the station entrance and replacing that section with a cycle path."

"This is a horrible junction/crossing, for pedestrians but even more so for cyclists. Because of the steep hill drivers tend to be very fast. Because of the road layout, and parking it can be hard to find a safe moment to cross, since drivers often come from multiple directions and will generally not let pedestrians or cyclists cross first."

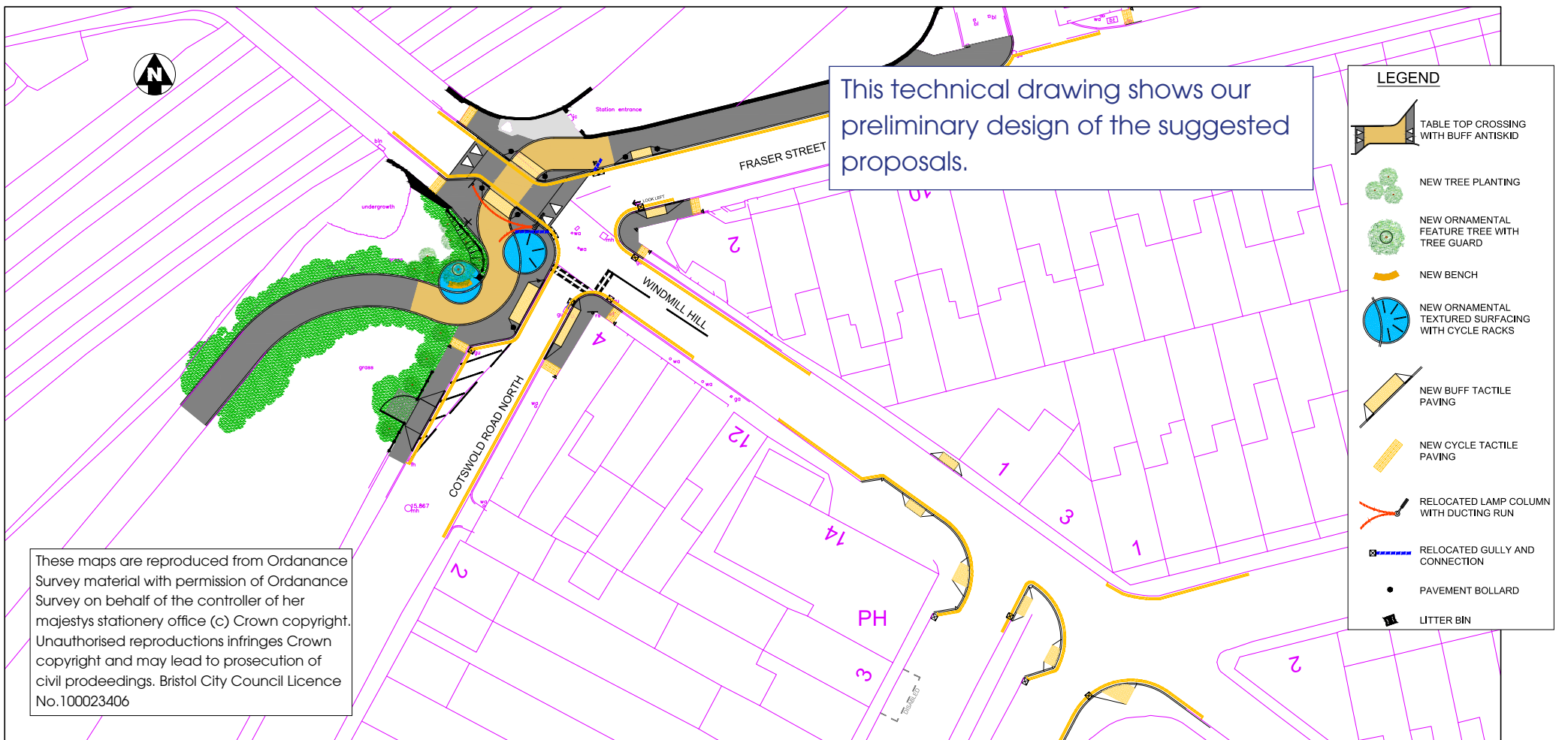

Programme

The current programme for delivery of the junction improvement is:

Date	Action
November 2016	Inform residents and local businesses
January 2017	Commence detailed design
March 2017	Start statutory consultation for Traffic Regulation Order
Late 2017	Construction

Local Traffic Scheme

Date	Action
November 2016	Inform residents and local businesses
January 2017	Commence detailed design
February 2017	Start statutory consultation for Traffic Regulation Order
Summer 2017	Construction

Comments and feedback

You can provide comments on the proposals and give us your feedback.

You can send an email to: CAF@bristol.gov.uk

Alternatively, you can write to us at:

Cycle Ambition Fund, City Transport, City Hall 3C, PO Box 3176,
Bristol, BS3 9FS

Please respond by Friday 16 December 2016

A statutory consultation for associated Traffic Regulation Order will be undertaken in 2017. Further comments can be submitted then.